



Order Form

Made-to-Length 100mm Linear Drainage

Product Details

Product Code 100AAi20MTL
Grate Style Wave Grate
Stormtech Range 100
Channel Material Stainless Steel
Grate Material Aluminium

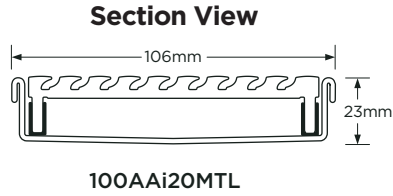

Finish / Code

- Standard / Satin** 100AAi20MTL
- Matte Black** 100AAi20MTL-Black
- Brass Gold** 100AAi20MTL-BG

Please note: Only Aluminium grate is finished, channel is stainless steel

Specify Length, Outlet Size and Position

1. Label

mm

Outlet Size

- 38mm 44mm
- 51mm 63mm
- 76mm 89mm

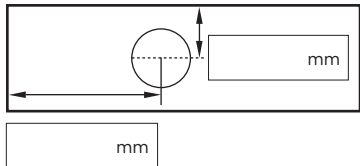

Notes

2. Label

mm

Outlet Size

- 38mm 44mm
- 51mm 63mm
- 76mm 89mm

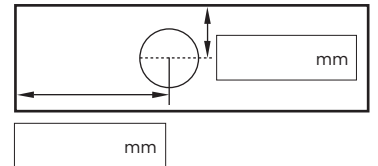

Notes

3. Label

mm

Outlet Size

- 38mm 44mm
- 51mm 63mm
- 76mm 89mm

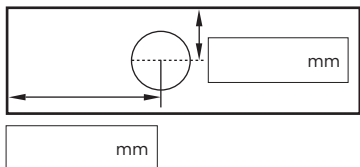

Notes

4. Label

mm

Outlet Size

- 38mm 44mm
- 51mm 63mm
- 76mm 89mm

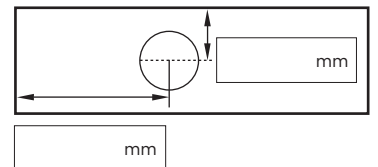

Notes

5. Label

mm

Outlet Size

- 38mm 44mm
- 51mm 63mm
- 76mm 89mm

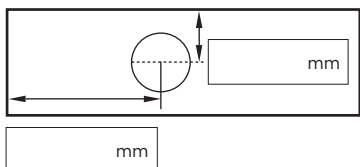

Notes

6. Label

mm

Outlet Size

- 38mm 44mm
- 51mm 63mm
- 76mm 89mm

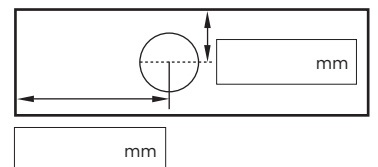

Notes

PLEASE NOTE See AS3500 standard & local regulator for specific outlet/drain requirements. Grates longer than 1500mm are supplied in multiple sections. Channels are a maximum 3000mm in one piece, channels over 3000mm are supplied in multiple sections with joiner. +/- 2mm tolerance on dimensions.

Full Name

Company Name

Project Name / Project Stage

Distributor or Contact

Telephone or Email

Order Number

Stormtech Quote Number